

### 閘門水堰及高水路橫断面圖

縮尺 縱 1:400  
橫 1:300

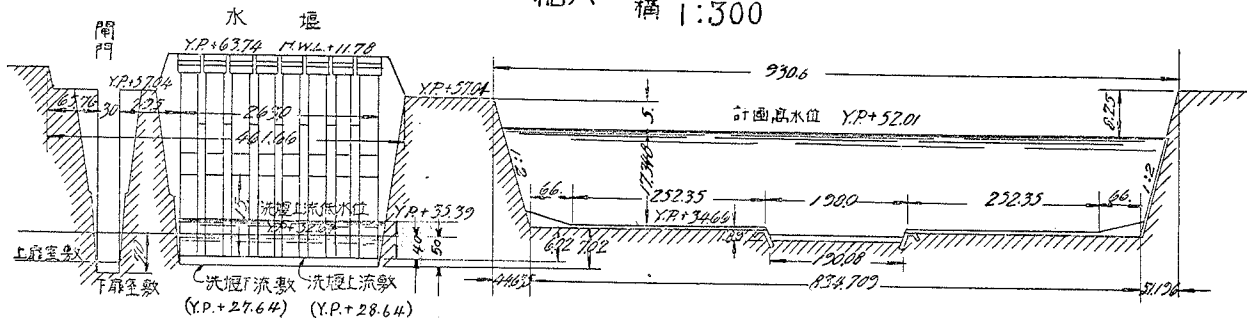

### 高水路縱断面圖

縮尺 縱 1:200  
橫 1:600

### 低水路水位一覽圖

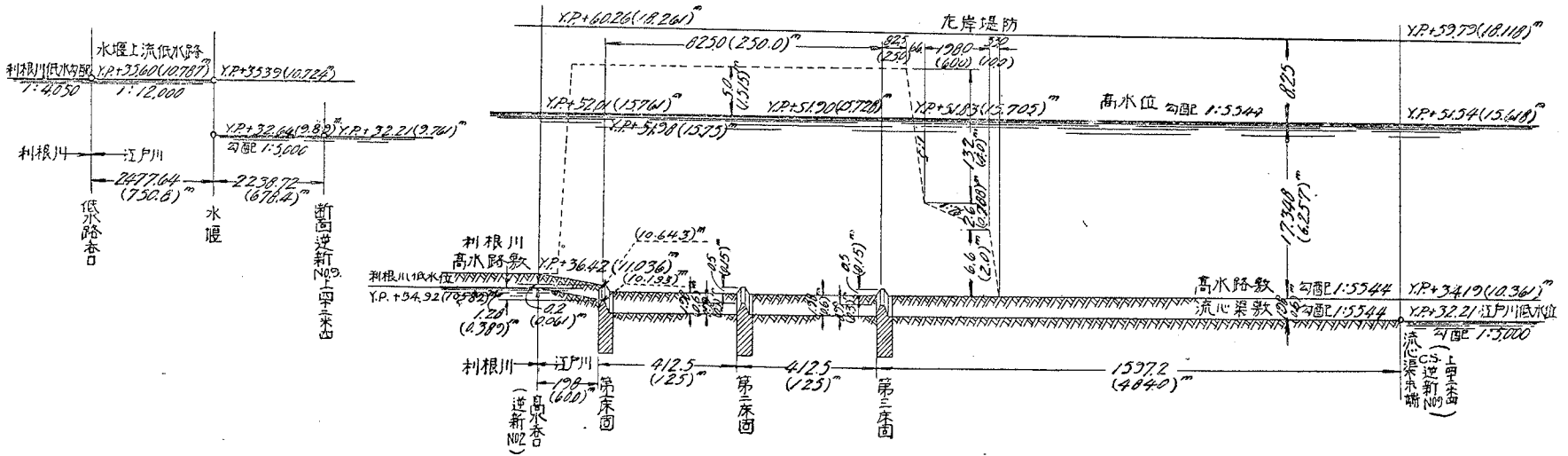

### 閘宿水堰

正面

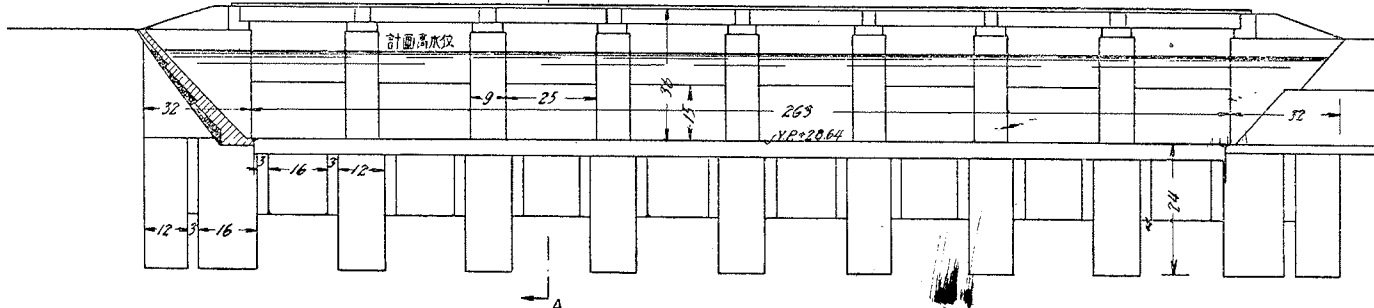

地質

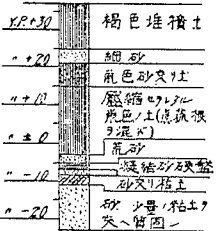

閘室

B-B

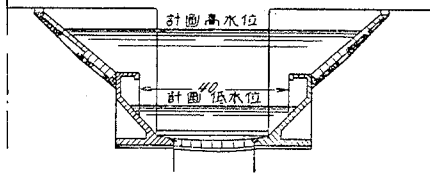

縮尺 六百分之一

### 閘宿開門

縱断面

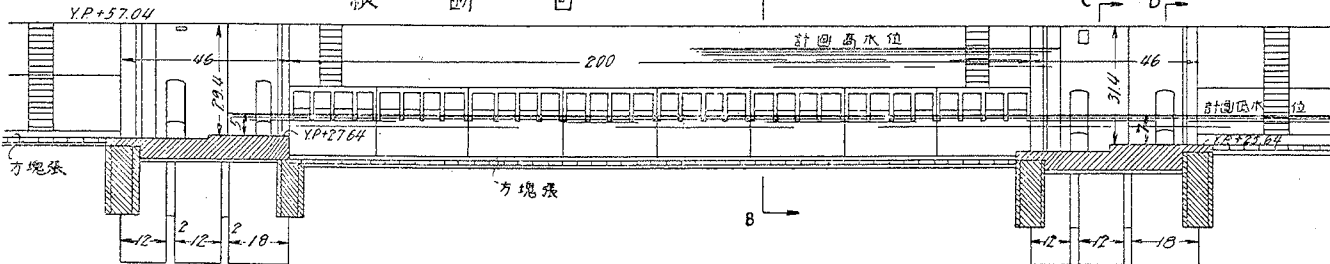

閘室 [下]

C-C | D-D

